



# **FASTEST MANUFACTURER IN INDUSTRIAL & COMMERCIAL R.O. SYSTEM**

**INDUSTRIAL R. O. SYSTEM**

**COMMERCIAL R. O. SYSTEM**

**MINERAL WATER PLANT**

**ISI APPROVED PLANT**

**D. M. PLANT**

**ICE FACTORY (MINI PLANT)**

**LIME SODA PLANT**

**SWIMMING POOL FILTRATION SYSTEM**

**INDUSTRIAL WATER TREATMENT**

**WATER TREATMENT CHEMICALS**

**ONLINE CHILLER**

**COOL JUG**



**UNICARE**  
TECHNOLOGIES PVT. LTD.

## ABOUT COMPANY

We introduce ourselves as Company in the field of Manufacturing High Pure Water Treatment Plants. We cater to the needs of Industrial Establishments, Bottled Water Projects, Electronic Industries, Pharmaceuticals, Hospitals, Major Hotels, Large Residential Complexes & Swimming Pool Filtration plants with their Accessories.

We can offer you state-of-the-art fully automatic operational plants, which confirm to the standards set by B.I.S. (Bureau of Indian Standards), Our Water Treatment Plants can be designed for any capacity for the applications. Our systems are designed after extensive research to meet the challenges of the modern usages, consequentially offering clean, chemical-free and odorless water.



**FAST, RELIABLE AND COST I**

## VISION & MISSION

We are in the business to serve the customer. He is the most important person. He is the only one who pays. He deserves the best quality and presentation at a worth price. We must have world class quality, at the lowest production & distribution cost. This will make us an unbeatable leader, and will have satisfied loyal customers. Our vision is to be the dominant player in the branded water business where the second player is less than 20% of our business.

## INTRODUCTION OF WATER

Water is our lifeline that bathes us and feeds us. In ancient cultures water represented the very essence of life Water (H<sub>2</sub>O, HOH) is the most abundant molecule on Earth's surface, constituting about 75% of the planet's surface. In nature it exists in liquid, solid, and gaseous states. At room temperature, it is nearly colorless with a tint of blue, tasteless, and odorless liquid. Many substances dissolve in water and it is commonly referred to as the universal solvent. Because of this, water in nature and in use is rarely pure and some of its properties may vary slightly from those of the pure substance.

Water borne diseases are any illnesses caused by drinking contaminated water. Diseases can include infection from bacteria (Salmonella), viruses, or by small parasites (Cryptosporida, Giardia, and Toxoplasma). These organisms and viruses cause diseases like cholera, typhoid fever, malaria, botulism, polio, dysentery, giardia, and hepatitis A. One of the first symptoms of these diseases is diarrhea, which cause about three million deaths throughout the world, mainly in India, Africa, and South America.



## **WE OFFERS**

**INDUSTRIAL R. O. SYSTEM**

**COMMERCIAL R. O. SYSTEM**

**MINERAL WATER PLANT**

**ISI APPROVED PLANT**

**D. M. PLANT**

**ICE FACTORY (MINI PLANT)**

**LIME SODA PLANT**

**SWIMMING POOL FILTRATION SYSTEM**

**INDUSTRIAL WATER TREATMENT**

**WATER TREATMENT CHEMICALS**

**ONLINE CHILLER**

**COOL JUG**

### **TURNKEY SOLUTIONS FOR**

Mineral water bottling plant which confirm to the standards set by B.I.S. (Bureau of Indian Standards).

Reverse Osmosis Plants for High Purity Process Water used in Industrial Applications.

Water Treatment for Air Conditioning Plants/ Cooling Towers, Boiler Feed Water etc.

Hard water conversion to Soft water / Highly Pure Drinking Water Units.

Iron / Pesticide removal from Bore well water.

Effluent and Sewage Treatment Plants as per Pollution Control Norms.

**WE ALSO SUPPLY COMPLETELY AUTOMATIC PLANTS WHERE THE LABOR REQUIREMENT IS CUT DOWN TO A MINIMUM LEVEL AND THE FULL PLANT RIGHT FROM THE BOREWELL TO THE END PRODUCT IS AUTOMATED.**

## REVERSE OSMOSIS SYSTEM

The Reverse Osmosis Process uses a semipermeable membrane to separate and remove dissolved solids, organic, submicron, colloidal matter, viruses, and bacteria from water. The process is called "reverse" osmosis since it requires pressure to force pure water across a membrane, leaving the impurities behind. Reverse Osmosis is capable of removing 95-99% of the total dissolved solid (TDS) and 99% of all bacteria, Thus providing safe, Pure Water.

Vrajesh Corporation apply state of the art technology to offer the industries most advanced, high performance extremely effective and economical water treatment plant. Custom Engineers total water solution is the keyword at Vrajesh Corporation.

From understanding the application and requirement to conception and designing of the system and finally the implementation, Vrajesh Corporation work in partnership with its client providing total customized-solution to virtually any industry, commercial and home establishment, at a cost which is highly economical.



### PRODUCT RANGE

250 LPH, 500 LPH, 1000 LPH, 1500 LPH,  
2000 LPH, 3000 LPH, 6000 LPH .....  
Up to 20,000 LPH.

### FEATURES

- System in Operation Indicator
- Digital TDS Meter
- Product Water Flow Meter
- Low Pressure Switch or Water Float control
- Feed Water Pressure Gauge
- Product Water Pressure Gauge
- Stainless Steel R. O. High Pressure Vessels
- Stainless Steel R. O. High Pressure Pump





## FEATURES

Boiler feed water
Cooling tower
Effluent Treatment
Process Water
Dyes & Intermediates
Oral Suspensions
Drinking Water
Water for Injection - WFI
Food & Beverages
Soft Drink
Tablet Manufacturing
Battery Water
Power Plant & Cement
Bottled Water

## SAFETY FEATURES

Auto Flow Level Control System
Auto Temperature Control System
Overload Protection System
Single Phase Preventer
Digital AMP Meter
Digital volt Meter
Phase Indicator



All the Control devices are fitted inside the control panel, which is mounted on the machine itself. All the motors have thermal relays which protect them against voltage surges and excessive current.

## TECHNICAL SPECIFICATION OF PLANT

Model	UTPL-250	UTPL-500	UTPL-1000	UTPL-2000	UTPL-3000	UTPL-4000	UTPL-6000	UTPL-10000
Capacity (LPH)	250	500	1000	2000	3000	4000	6000	10,000
Raw Water Flow	700 LPH	1250 LPH	2500 LPH	4500 LPH	7500 LPH	10,000 LPH	14,000 LPH	24,000 LPH
Inlet Dia	25.400 mm	25.400 mm	31.750mm	38.100mm	50.800mm	50.800mm	50.800mm	63.500mm
Raw Water TDS	<2200 TDS & <250 PPM Hardness							
Raw Water Temperature	22°C to 40°C							
Display	TDS Meter, Flow Meter, Pressure Meter, Volt Meter, Amp Meter							
Vessels	FRP / SS							
Voltage	220 Volt 50Hz Single Phase / 440 Volt 50Hz 3Phase							
Power	2.0 kW	3.0 kW	4.0 kW	5.0 kW	6.0 kW	7.5 kW	9.75 kW	15.0 kW
PUMP OPTION	Grundfos , Sumo, CNP, DP							
MEMBRANE BRAND OPTION	Dow, Hydranautics							

## OZONE GENERATOR

Ozonation of water is accepted worldwide as the most efficient and nature friendly process to purify water.

Power 3000 times more powerful than chlorine.

Safe leaves no by-products, unlike chlorine. which forms carcinogenic compounds (THMS) with organic compounds.

Predictable More predictable than UV sterilization.

Other benefits The decolorizing and deodorizing properties of Ozone make water sparkling clear.

## OZONE APPLICATION

Drinking Water treatment.

Mineral Water treatment.

Swimming pool water treatment.

Effluent treatment.

Pharmaceutical Water treatment.

Electronics Ind. Water treatment.

To reduce COD/TOC.

Medical Applications.

Air Treatment and air purification

.....and many more applications.



## ULTRAVIOLET WATER PURIFIERS

Ultra Safe Ultraviolet Water Purifiers are manufactured from stainless steel 304/316/316L/FRP. The Radiation chamber is mirror polished from the inside and outside thus reflecting max amount of radiation. Both the ends are flanged for easy operation, maintenance and servicing.

Specially designed reflectors give additional U.V. reflection to get maximum efficiency. Units are designed to get maximum retention time and turbulence of water for better results. The U.V. Lamps are housed in quartz sleeve and assembled in Stainless Steel Shells. Each quartz jacket is provided with a specially designed wiper assembly for removing any particles that get settled on the Quartz tube.

The wiper assembly is specially designed for easy operation without stopping the operation of the unit. The system is completely sealed to avoid any harmful effects from U.V. addition. All wetted rubber parts are made of Food Grade Silicon Rubber to avoid bad ailer & detracton due to U.V. radiation.





## BOTTLING MACHINE

The Machine is suitable for 500ml/1000ml/1500ml/2000ml, PVC/PET Bottles and has a production capacity of 30 to 60 Bottles per minute. The Machine has two sets of operations.

1. Automatic operations – bottle rinsing, bottle filling, cap pick up, Capping and shrink sleeving inside shrink tunnel.
2. Manual Operations – empty bottle loading, visual inspection, sleeve/label insertion, finished bottle unloading and auxiliary functions like carton handling, carbon sealing, etc.



### MACHINERY DETAILS

#### (REFER TECHNICAL SPECIFICATION TABLE).

Complete unit in Stainless Steel 304

All pumps in Stainless Steel 304

Final Rinsing & Filling Line in Stainless Steel 304

Hot water washes with heater & tank provision.

Fully PLC controlled operations.

Automatic Capping

Outer washing of Jar with high pressure.

(Stainless Steel Model)



### OPERATIONAL AND TECHNICAL SPECIFICATIONS OF THE MACHINE ARE DESCRIBED BELOW:

The conveyor systems

Empty bottle handling (Rinsing rotor)

Bottle handling (Filling rotor)

Cap pick up

Capping operation

Shrink Sleeving

### 20 LTRS. JAR SEMI / FULLY AUTOMATIC WASHING, RINSING, FILLING & CAPPING MACHINE.

#### THE USE & SPECIALITY OF THE MACHINE

Introducing the new lifeline for your PET and PC jars. The fully automatic external & internal Jar washing machine with auto filling & capping for 10 & 20 ltrs Jars. Reduces labor requirement by 80%, and increases production by nearly 40-50%. Life of the jar is increased by 65% on the whole. Avoiding scratches, dents and impact cracks due to manual handling and option for the new age automated state of the art jar washing machine.

## WATER SOFTENER

A water softener is a unit that is used to soften water, by removing the minerals that cause the water to be hard. When water is referred to as 'hard' this simply means, that it contains more minerals than ordinary water. These are especially the minerals calcium and magnesium. The degree of hardness of the water increases, when more calcium and magnesium dissolves. Magnesium and calcium are positively charged ions. Because of their presence, other positively charged ions will dissolve less easily in hard water than in water that does not contain calcium and magnesium. This is the cause of the fact that soap doesn't really dissolve in hard water. Water softening can prevent these negative effects.

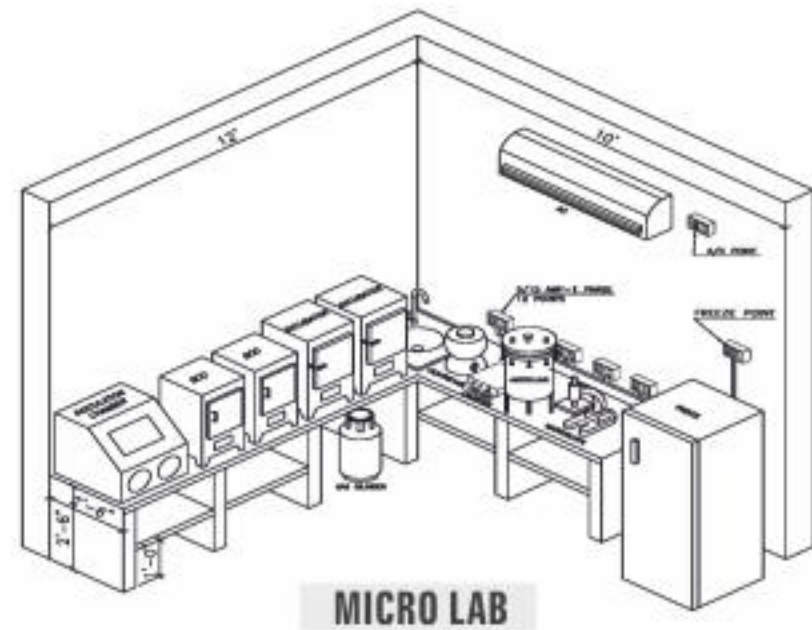
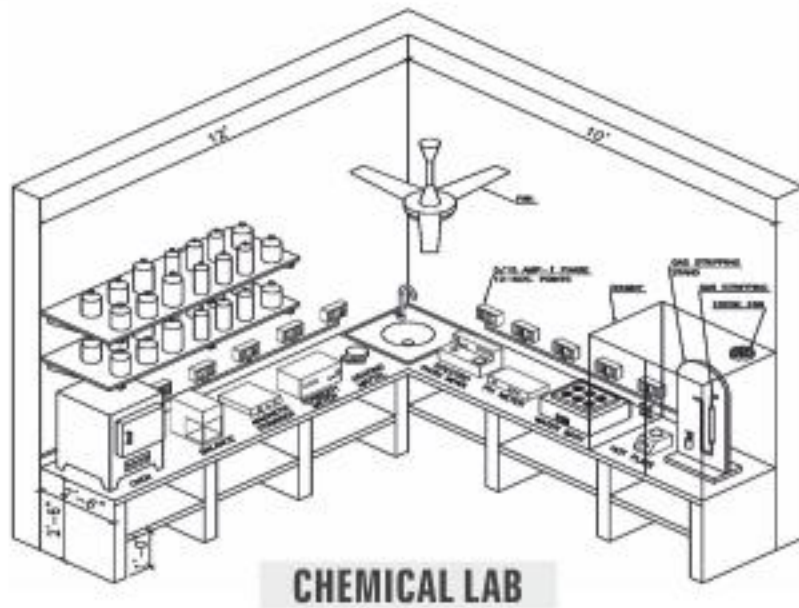

## R.O. PLANT





## DEMINERALIZATION (DM)

The DM plant purifies water by removing extraneous mineral ions from input water.

The process of ion-exchange is the reversible exchange of ions between a solid (synthetic resin) and a liquid in which there is no substantial change in the structure of the solid. As the water is passed through a series of resin beds, the ionic content is removed by chemical reaction. The result is chemically pure water, from the standpoint of freedom from ionic constituents, but non - electrolytes such as organic compounds and micro-organisms may not be removed.

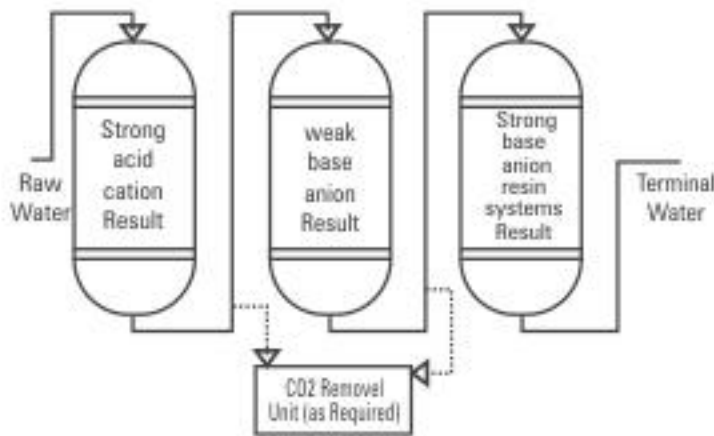

Systems are manufactured from MSRL, FRP, SS 316, Mild Steel etc. Standard models are available for a flow rate of 50 LPH to 1,00,000 LPH. Custom made models also available as per requirements.

### STRONG ACID CATION + STRONG BASE ANION RESIN SYSTEMS

### STRONG ACID CATION + WEAK BASE ANION + STRONG BASE ANION RESIN SYSTEMS

DM Regeneration Chart

Capacity	Hardness				
	< 10 PPM	< 20 PPM	< 30 PPM	< 40 PPM	< 80 PPM
VCD-100 LTR	48,000	24,000	18,000	12,000	6,000
VCD-200 LTR	96,000	48,000	36,000	24,000	12,000
VCD-500 LTR	2,40,000	1,20,000	90,000	60,000	30,000

## PRODUCT ASSOCIATES



## ARE OF APPLICATION





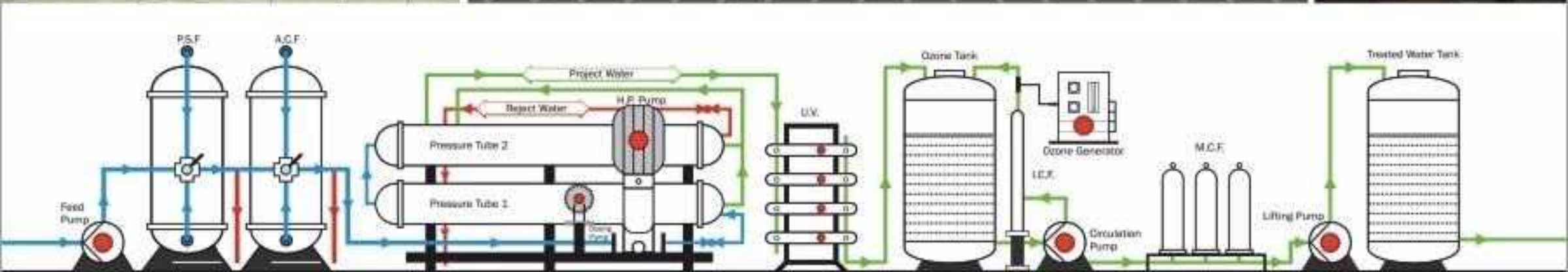
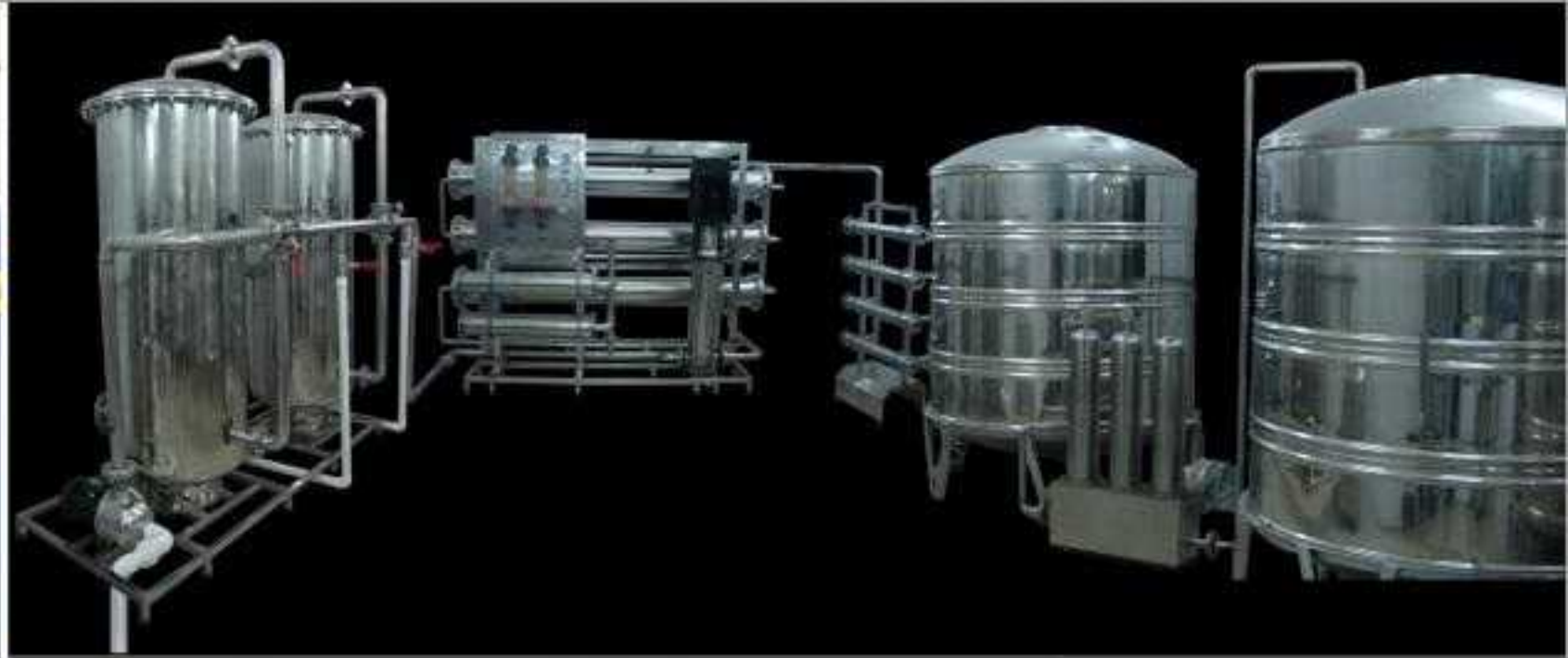



# UNICARE

TECHNOLOGIES PVT. LTD.



INDIA



Address: Gat No. 1327, Vrindavan Park, Opp. Kamal Motors, Nagar Road, Wagholi, Pune - 412207 Maharashtra, (India)

Contact Number : +91 9823009383

E-mail : [salespune@unicarewater.com](mailto:salespune@unicarewater.com)

Website : [www.unicarewater.com](http://www.unicarewater.com)